



## SPECIFICATION S330

### PRINCIPAL DIMENSIONS *(According to ISO 8666)*

<b>LOA</b>	10.31 m	33' 10"
<b>LH</b>	9.99 m	32' 9"
<b>Beam</b>	3.50 m	11' 6"
<b>Draught single engine</b>	1.09 m	2' 9"
<b>Draught double engine</b>	0.89 m	2' 11"
<b>Height above waterline inc. mast</b>	3.30 m	10' 10"
<b>Height above waterline excl. mast</b>	2.72 m	8' 11"
<b>Headroom minimum approx.</b>	1.85 m	6' 0"
<b>Fuel capacity</b>	570 l	125 UK gal
<b>Water capacity</b>	220 l	48 UK gal
<b>Displacement approx.</b>	6700 kg	6.59 tn.l.
<b>Max people on board</b>	8	
<b>CE Category</b>	B	

### ENGINE STANDARD

1 x Volvo Penta D6 330 hp, Duoprop Sterndrive 27/28knots\*  
Propeller: G3

### ENGINE OPTIONS

1 x Volvo Penta D6 400 hp, Duoprop Sterndrive 31/32 Knots\*  
Propeller: G2

2 x Volvo Penta D3 220 hp, Duoprop Sterndrive 31/32 knots\*  
Propeller: IH4

\*All performance figures are given in good faith and are intended as an indication. These figures cannot be guaranteed as top speed in particular is affected by the cleanliness of the hull, conditions of the propellers, weight carried and air/sea temperature. SEALINE reserves the right to change specifications in line with the company policy of improvement through research and development. Errors and omissions expected. Please check with your dealer for a full list of inclusions.

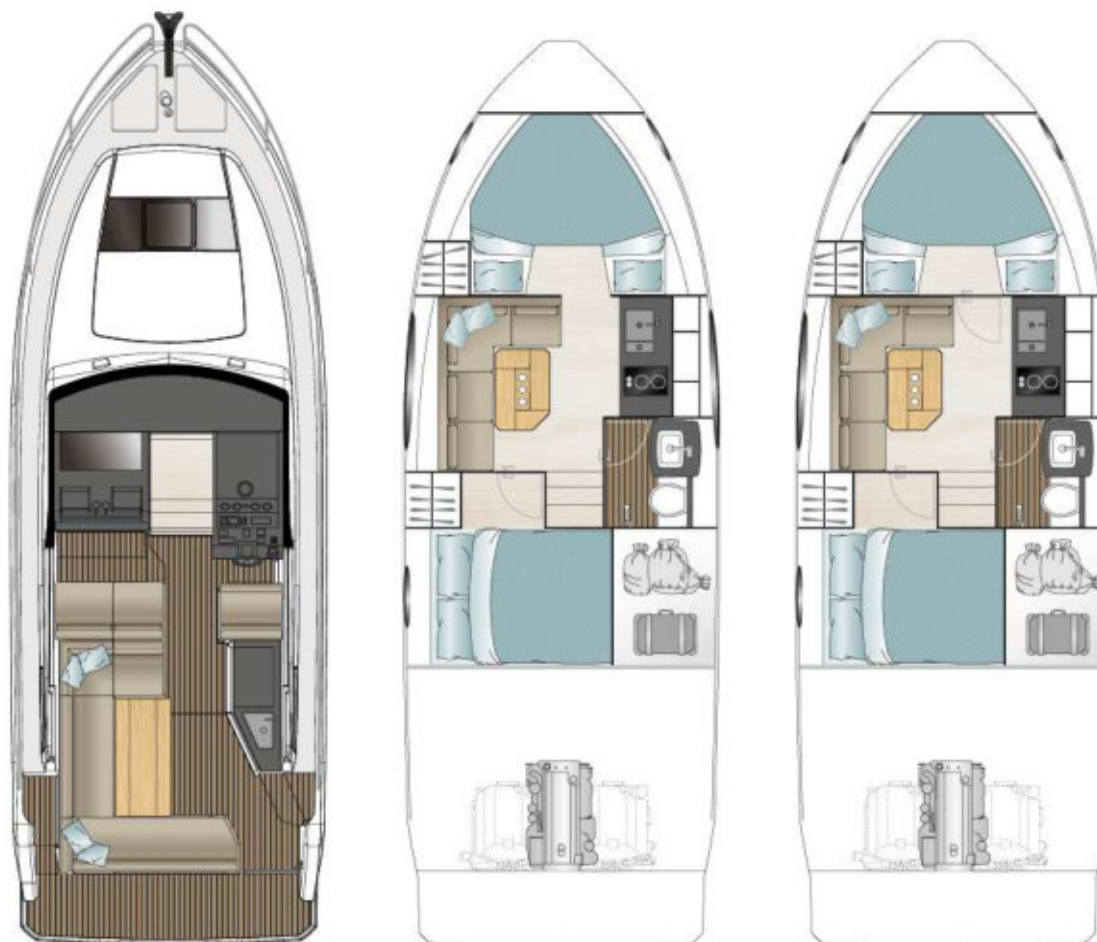

Main Deck

Lower Deck

Lower Deck option

# SEALINE S330

## STANDARD SPECIFICATION

### DECK

- Anchor Hauser Stainless steel
- Anchor locker, self draining
- Deck, moulding non-slip
- fendering strip black rubber
- Fuel and water deck inlets
- Foredeck hatch, opening
- Navigation lights
- Stainless steel pulpit rail, stainless steel top rail and wire below forward angled
- All cleats are stainless steel
- 4 mooring cleats
- One piece windscreen

### COCKPIT AND BATHING PLATFORM

- Aft pillars in anthracite
- Engine room access with electric opening
- Ensign socket and staff
- Fuel shut-off valves
- Gas bottle locker with drain
- Handrails in stainless steel
- Cockpit Lighting
- Saloon door, sliding in Plexiglass (translucent)
- Sealine convertible fabric roof system
- Seating, U-shaped sofa with two copilot seats
- Storage lockers
- Bathing platform, self draining
- Stainless steel bathing ladder foldable
- Transom door to stbd in stainless still
- Transom shower with hot and cold water
- Wet bar with sink and storage

### HELM POSITION

- Compass
- Drinks holders (2) in copilot area
- Engine instrumentation
- Engine controls
- Teak like footrest at helm
- Fuel gauges
- Helm seat with storage underneath
- Rudder angle indicator
- Socket, 12 V
- Steering wheel, fixed angle

### SALOON

- Skylight
- Sockets, 230 V

- Storage lockers overhead
- Table, fixed leg with insert glass holder
- Electrical control panel for 220 V AC and 12 V DC circuits
- Lighting, overhead
- Indirect lights (Led)
- Portholes
- Seating, L-shaped

### GALLEY

- Cutlery drawer and tableware storage
- Fridge
- Lighting, overhead
- 1,5 Sink, stainless steel with mixer tap
- Socket, 230 V
- Storage cupboards and overhead lockers
- Stove, gas (2) burner

### FORWARD CABIN

- Berth, double V shaped with storage underneath
- Skylight with blinds
- Deck hatch,
- Eye level shelving
- Lighting, overhead
- Indirect lighting
- Reading lights
- Shelves
- Portholes
- Socket, 230 V
- Wardrobe to port

### AFT CABIN

- Berth double
- Lighting, overhead
- Portholes, (1) opening
- Socket, 230V
- Wardrobe to port
- Shelves
- Reading lights

### CABINS & DAY HEAD

- Hand basin with mixer tap
- Lighting, overhead
- Porthole, opening

- Shaver socket
- Shower drain with automatic pump
- Storage cupboard
- Toilet, manual

- Identified locations for hand held fire extinguishers - hand held fire extinguishers are not supplied
- Sealine owner's manual in Sealine bag

### ELECTRICAL

- AC system, 230 V with shore support system
- Batteries - domestic 2 x 160 Ah
- Batteries for engine 1 x 95 Ah with link switch
- Battery charger, 50 amp
- Remote battery switches
- Hot water boiler 22 liters
- DC system, 12 V
- Fresh water pump
- Water gauge
- Windscreen wipers, (2) with screen wash

### MECHANICAL

- Access hatch to engine room from cockpit (electrical)
- Bilge pumps, automatic and manual
- Engine room sound isolation
- Engine room fans
- Engine room light
- Fire extinguisher system, automatic and manual, in engine room
- Fuel tank
- Fuel filter for engine
- Steering, hydraulic (with standard single engine)
- Water tank
- Holding tank with deck outlet

### DÉCOR

- Skylight, salon and aft cabin
- Wood flooring
- Companionway steps with safety treads
- Door frames, in wood
- Furniture finished in plywood with walnut style
- Galley counter tops in Bistro, frames in Corian®
- Toilet counter top
- Upholstery seating - from selection
- Convertible roof, silver color
- Dash, matt finish
- Mattresses

### MISCELLANEOUS

- Hull white gelcoat
- Gelcoat waterline in balck